

**COMPARISON HARMONICS: MONASTERY AND "LINDISFARNE-L" (FROM LINDISFARNE GOSPELS)**

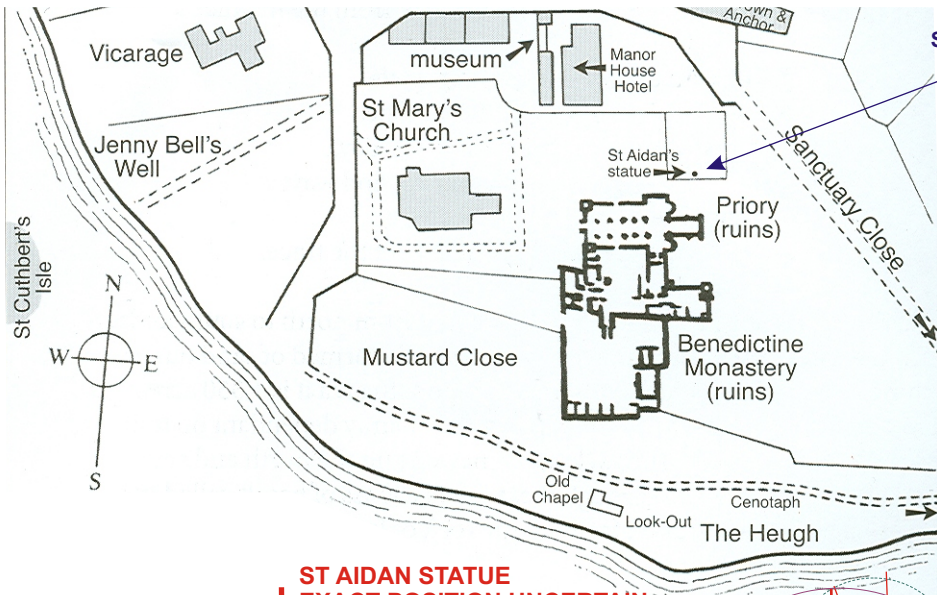

**ST. AIDAN'S STATUE**

**....EXACT POSITION UNCERTAIN....  
ST. AIDAN'S STATUE APPEARS TO BE ON MAIN AXIS**

**PHI-SQUARED RHOMIC TIME GATE/PILLAR, FROM THE LINDISFARNE-L**

**ST AIDAN STATUE EXACT POSITION UNCERTAIN (SATELLITE IMAGE CLOUDED OVER)**

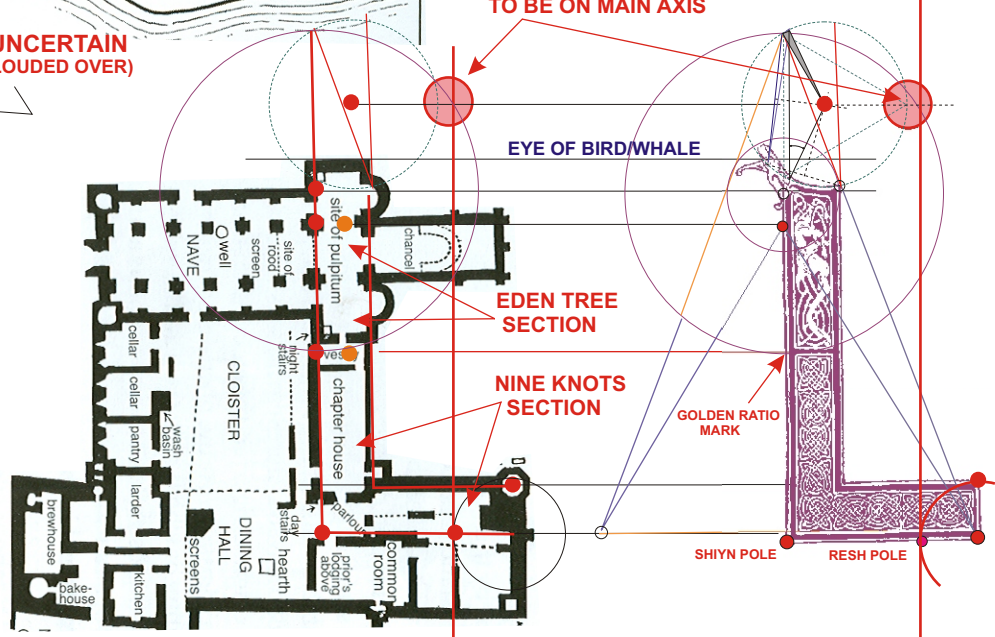
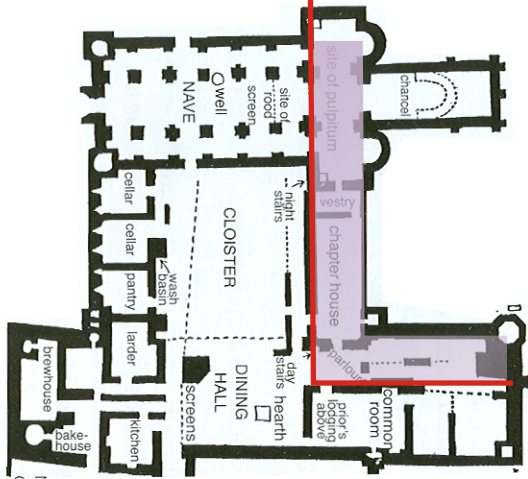

**NOTE: THE PRIORY IS POSITIONED IN THE "CHAIR/THRONE" SUCH THAT IT CAN REPRESENT THE "DESTINY STONE" IN THE THRONE. AS SUCH THE PHI "L-GATE" ALSO INCLUDES THE RESHEL (CHIEF HEAD STONE).**

**THE "L-PILLAR/GATE" IN THE PRIORY IS THE TYPICAL FEMALE "YAHCHAN" PILLAR OF THE TEMPLE. THE STATUE POINT APPEARS TO BE THE VAU POLE IN THE RESHEL.**

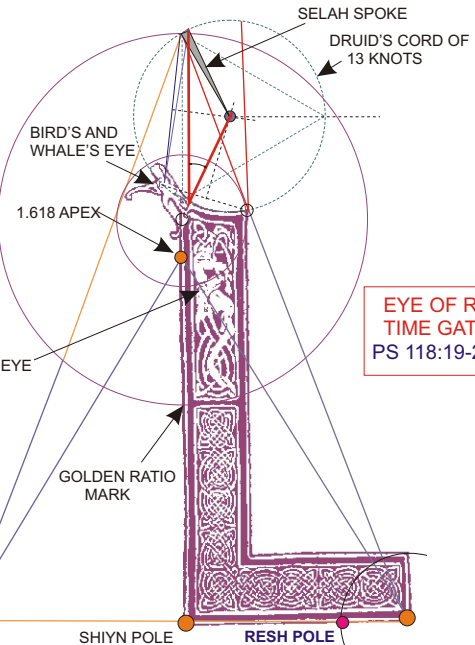

**EYE OF RA TIME GATE PS 118:19-23**

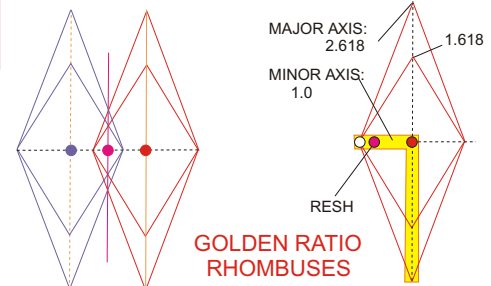

**THIS IS A ROUGH DRAFT PRELIMINARY IN-HOUSE STUDY, NOT FOR FURTHER PUBLICATION PENDING PERMISSION TO USE GRAPHICS.**

File: GridLindisfarneCtyMap02.cdr  
Geometry Copyright 2007, William Buehler  
Bitmaps and St. Aidan rendition from "HOLY ISLAND, a short History and Guide" by Frank Graham; (2005 edition).

**ILLUMINED "L" FROM LINDISFARNE GOSPELS: "L-GATE" SHOWING THE PRIMARY CONSTRUCTION LINES AND SACRED CHORDS. (BASIC ORGANIZATION, INTERMEDIATE STAGE.)**