

ROSSLYN CHAPEL SHOWING BASIC RESHEL WITH 3 LEVELS OF CHAMBERS ENVISIONED BY BETH DAVIES.

CORRELATIONS WITH CHAMBERS:

1. CHAMBERS ARE WITHIN THE CHRISTOS RESHEL HALF.
2. SHIYN POLE IS IN CH. 2, ABOVE LOWER CHAMBER.
3. POOL OF LIFE/MOON POLE IS AT EDGE OF CH. 5
4. CHAMBER OF THE SON IS IN CH. 2.
5. L-GATE IS IN CH. 5.
6. ALPHA POLE IS IN THE 1ST CHAMBER (UPPER ONE).
7. SACRED VAULT OF THE SUN ON EDGE OF CH. 4.
8. CHRISTOS RESH POLE AT EDGE OF CH. 1.
9. MIDDEN CH. IN MIDDLE OF CH. 3.

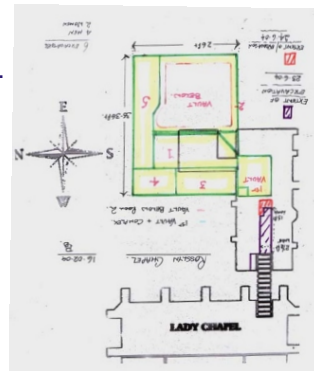

CHAMBER PLAN
COPYRIGHT © 2004, BETH DAVIE

THREE LEVELS OF CHAMBERS ENVISIONED

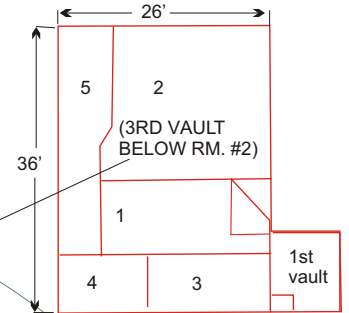

UPPER RESHEL SPEAR IS THE SPIRIT-TO-MATTER FUNCTION CONTROLLED BY SPIRIT. MOST OF IT'S POLES ARE EXTERNAL TO THE BUILDING

PRIMARY SPINNER RING AND SPHERE.

POOLS OF SINN (MOON, LIFE) AND THRESHOLDS OF SYTHIA DEFINE THE TEMPLE VAULT

BAPHOMET (SKULL is now the Christic Chief Head Stone: RESHEL.)

8-POINT WHEEL

ARC OF SPINNER ROTATION OF THE MATTER-TO-SPIRIT RESHEL SPEAR.

TEMPLE VAULT

ARIEOPAX SOLAR-IS RING; ROTATES THE TSADEY (GLORY) POLE MANIFESTING LIFE SPIRALS. NOTE THE 1ST STATION ACTION.

SPHERE CONTAINING THE TEMPLE VAULT GEOMETRIC. THE "MOON" SPHERE. A HARMONIC OF THE SHIYN OR "WOMB" POLE AT ROOD, SEE 2ND STATION.

SPIRIT-TO-GROUND POLE. 1ST STATION. (Transpose into the add-on Baptistry.)

File: RosslynPlanReshel02opening.cdr
COPYRIGHT © 1995, William Buehler
CHAMBERS COPYRIGHT © 2004, BETH DAVIE



CHAMBER OF THE SON

CHRISTOS ALPHA POLE AT MT SCHIEHALLION GROUNDS.

BASIC PLAN FROM "THE SWORD AND THE GRAIL" BY ANDREWSINCLAIR. GEOMETRY IS ORIGINAL BASED ON RESHEL AND ARIEOPAX FORMAT.